



PRENSILIA

GRASPING INNOVATION

POWERFUL

Up to 70 N maximum grip force available in all grasping patterns.

SMART

Embedded current, position and force* sensors allow for a variety of closed-loop control behaviours.

VERSATILE

Multi-grasp anthropomorphic gripper for multiple research scenarios: prosthetics, human machine interfaces, collaborative robotics, social robotics, manufacturing.

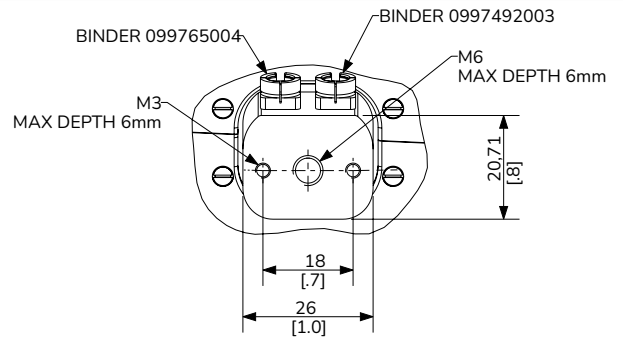
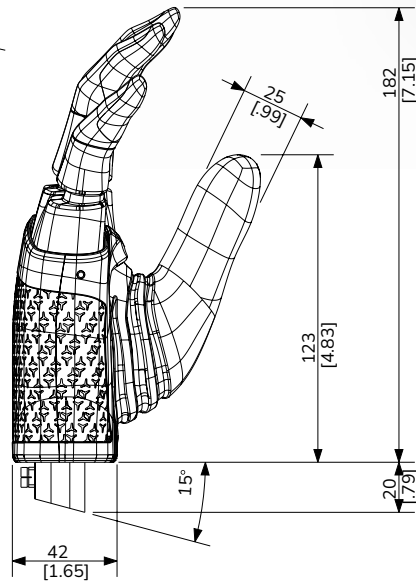
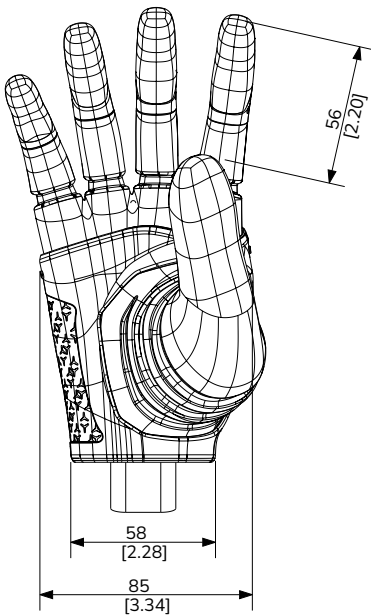

MECHANICAL SPECIFICATIONS

Weight	480 g
Size	82 x 40 x 190 mm
Grasp force	70 N
Degrees of actuation/freedom	3/4
Closure time	0.3 s
Coupled fingers	Middle/Ring/Little

CONTROL AND SENSORY SYSTEM

Embedded PID controllers	position, speed, force* (1 kHz)
Configurable pre-set grasps	5
Position sensors (digital): 3	0.1 deg
Motor current sensors (analog): 3	1 mA (10 bits)
Limit switches (digital): 6	-
Force sensors (analog)*: 3	~50 mN (10 bits)

ELECTRICAL SPECIFICATIONS

Power requirements	12V @ 6A peak
Communication	RS-232/USB

*force sensors on thumb, index and middle fingers available with Mia Sense